



# Universal Speaker Mount

For Speakers Weighing up to 20lb (9kg)

## MODELS

### Universal Models:

<b>SPK811</b>	Black
<b>SPK811W</b>	White

## SPECIFICATIONS

### Tilt | Swivel | Roll

±37.5° | 360° | ±37.5°

### Max load

20lb (9kg)

### Product Dimensions (W x H x D)

3.27" x 1.68"-3.97" x 2"  
(83 x 43-101 x 51mm)

### Mounting Surfaces

Wood stud, metal stud,  
concrete and drywall

### Ship Weight

.9lb (.4kg)

1. Ball and socket design provides 37.5° of rotation up or down
2. Concealed mounting screws
3. Flush mounted or used with 3" (76mm) extensions
4. Include hardware for mounting most commercially available speakers
5. Include fasteners for wood studs, metal studs, concrete and drywall
6. Speaker attachment hardware included
7. Internal speaker wire management



## TECHNICAL DRAWINGS

For expanded product information and technical data visit [www.peerlessmounts.com](http://www.peerlessmounts.com)

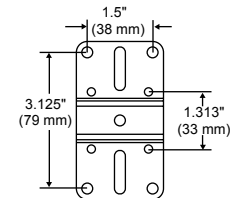
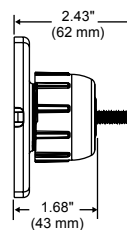
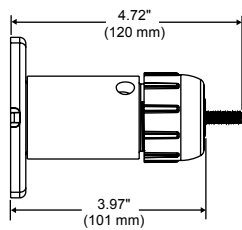

To verify mount compatibility with any LCD, plasma or projector model use MountFinder™ at [www.peerlessmounts.com](http://www.peerlessmounts.com)



CLICK: [www.peerlessmounts.com](http://www.peerlessmounts.com)



CALL: 800.865.2112



FAX: 800.359.6500