

# Installation and Assembly - Projector Adapter Plate for MAXX 1400 Projector

Model: PJC 218

**IMPORTANT!** Read entire instruction sheet before you start installation and assembly.

Before you start check the parts list below to make sure all of the parts shown are included.

## ⚠ WARNING

- Installer must verify that the ceiling will safely support four times the combined weight of all attached equipment and hardware.

### Parts List

Description	Qty.	PJC 218
<b>AA</b> adapter plate	1	055-1301
<b>BB</b> M6 x 20 mm serrated washer head socket pin screw	3	510-9554
<b>CC</b> spacer	3	540-9416

Note: Actual parts may appear slightly different than illustrated.

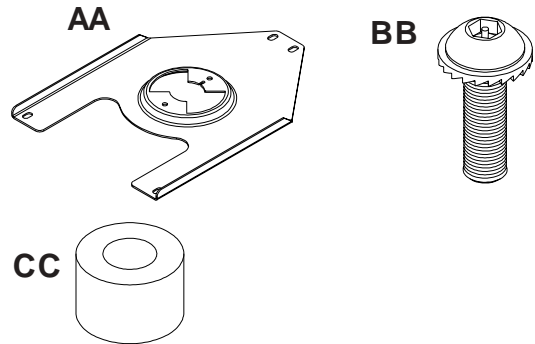

\*Notch indicates front of projector.

- 1 Flip projector upside down. Fasten adapter bracket (**AA**) using three 20 mm serrated washer head socket pin screws (**BB**) and spacers (**CC**) as shown. Tighten screws (**BB**) using allen wrench provided with mount.

