

Installation and Assembly - Projector Adapter Plate for InFocus™ IN72, IN74 and IN76 Projectors

Models: PAP 276, PAP 276-S,
PAP 276-W

Before you start check the parts list below to make sure all of the parts shown are included.

IMPORTANT! Read entire instruction sheet before you start installation and assembly.

⚠ WARNING

- Installer must verify that the supporting surface will safely support the combined weight of all attached equipment and hardware.

Parts List

Description	Qty.	PAP 276	PAP 276-S	PAP 276-W
AA adapter plate	1	055-1679	055-4679	055-2679
BB M4 x 16mm socket pin screw	3	520-1087	520-2087	520-2087
CC retaining spacer .198 x .313 x .375h	3	590-2020	590-2009	590-2009
DD 4mm security allen wrench	1	560-9646	560-9646	560-9646

Note: Actual parts may appear slightly different than illustrated.

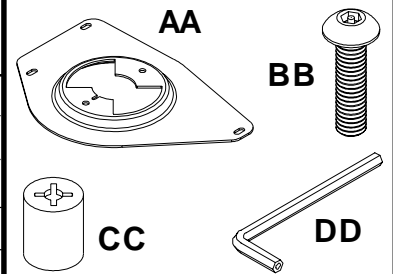

1

*Notch indicates front of projector.

Flip projector upside down. Fasten adapter plate (**AA**) using three retaining spacers (**CC**) and three M4 x 16mm socket pin screws (**BB**). Tighten M4 x 16mm socket pin screws (**BB**) through clearance holes in adapter plate (**AA**) using 4 mm security allen wrench (**DD**).

