

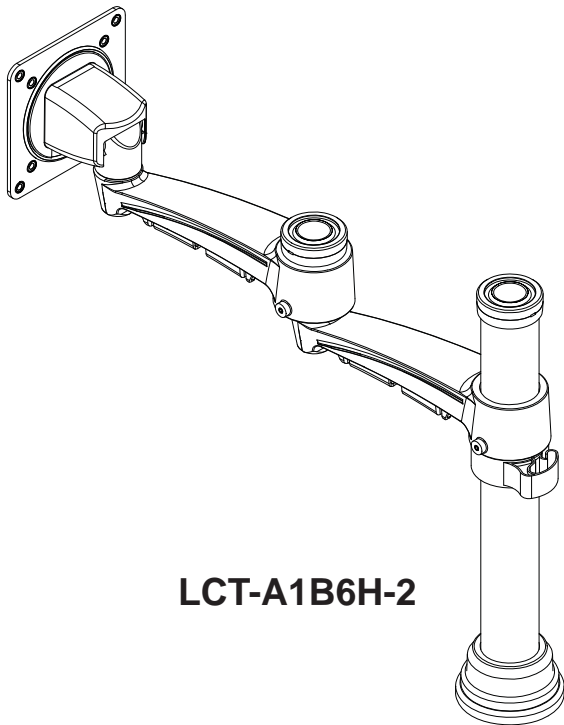

Installation and Assembly:

## Desktop Swivel Two-Link Pole for 15" - 24" LCD monitors

Models: LCT-A1B6C-2, LCT-A1B6H-2



LCT-A1B6H-2

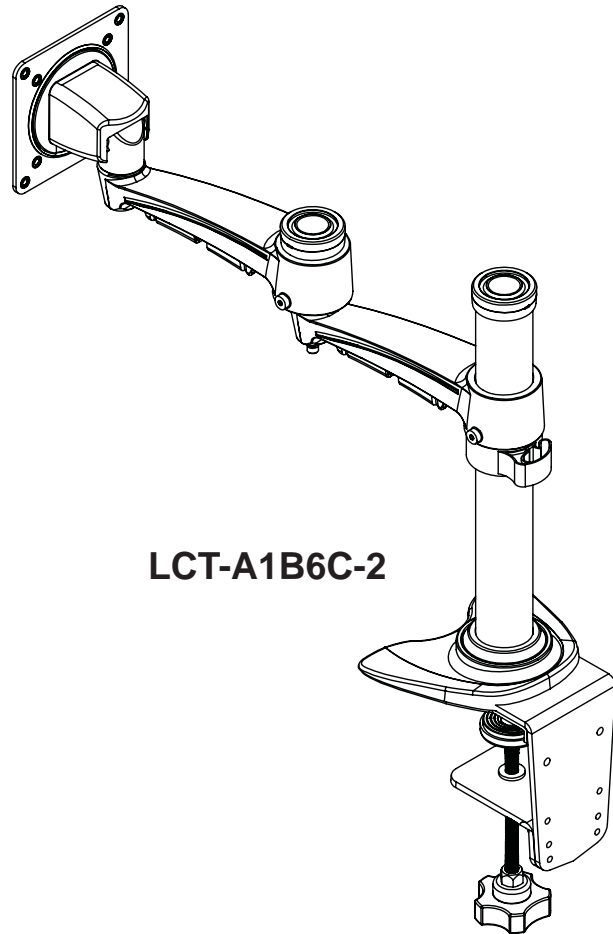

LCT-A1B6C-2

**Max Load Capacity: 17.6 lb (8 kg)**

**NOTE:** Read entire instruction sheet before you start installation and assembly.

## **WARNING**

- Do not begin to install your Peerless product until you have read and understood the instructions and warnings contained in this Installation Sheet. If you have any questions regarding any of the instructions or warnings, please call Peerless customer care at 1-800-865-2112.
- This product should only be installed by someone of good mechanical aptitude, has experience with basic building construction, and fully understands these instructions.
- Make sure that the supporting surface will safely support the combined load of the equipment and all attached hardware and components.
- Never exceed the Maximum Load Capacity. See page one.
- Always use an assistant or mechanical lifting equipment to safely lift and position equipment.
- Tighten screws firmly, but do not overtighten. Overtightening can damage the items, greatly reducing their holding power.
- Be sure to use designated fasteners and tools to assemble product. If correct fasteners and tools are not used, product may fail.
- When using clamp mounted product do not install arm until clamp is securely attached to mounting surface.
- When a monitor is not attached to arm assembly, arm may swing upward and cause harm to you or damage to product.

## **Table of Contents**

Parts List.....	3
Installation to Mounting Surface .....	4
Arm Assembly.....	5
Arm Height Adjustment.....	5
Installation to Screen.....	6
Control Bolt Tension Adjustment.....	6
Cable Management .....	7

*For customer care call (800) 865-2112 or (708) 865-8870.*

Before you begin, make sure all parts shown are included with your product.

Parts List		LCT-A1B6C-2	LCT-A1B6H-2
Description	Qty.	Qty.	Qty.
A	pipe assembly	1	1
B	arm assembly	1	1
C	M4 X 10mm screws	4	4
D	M4 X 16mm screws	4	4
E	M4 X 8mm screws	2	2
F	lower pipe cap	1	1
G	upper pipe cap	1	1
H	bolt	—	1
I	spring washer	—	1
J	flat washer	—	1
K	bottom washer	—	1
L	2.5mm allen wrench	1	1
M	4mm allen wrench	1	1
N	8mm allen wrench	—	1

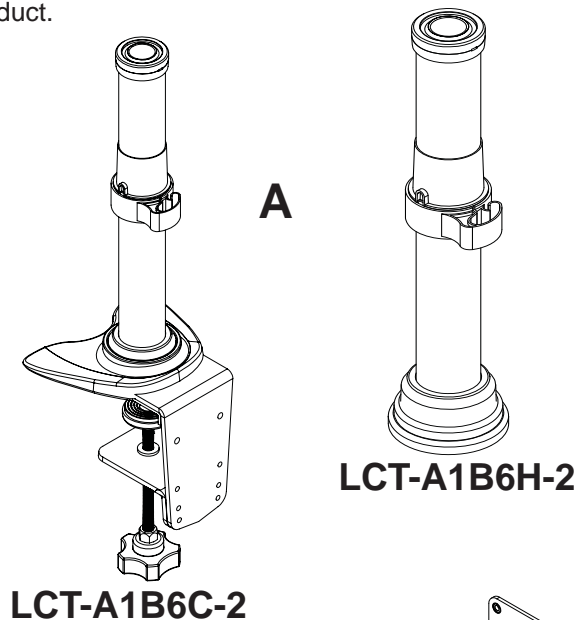

Parts may appear slightly different than illustrated.

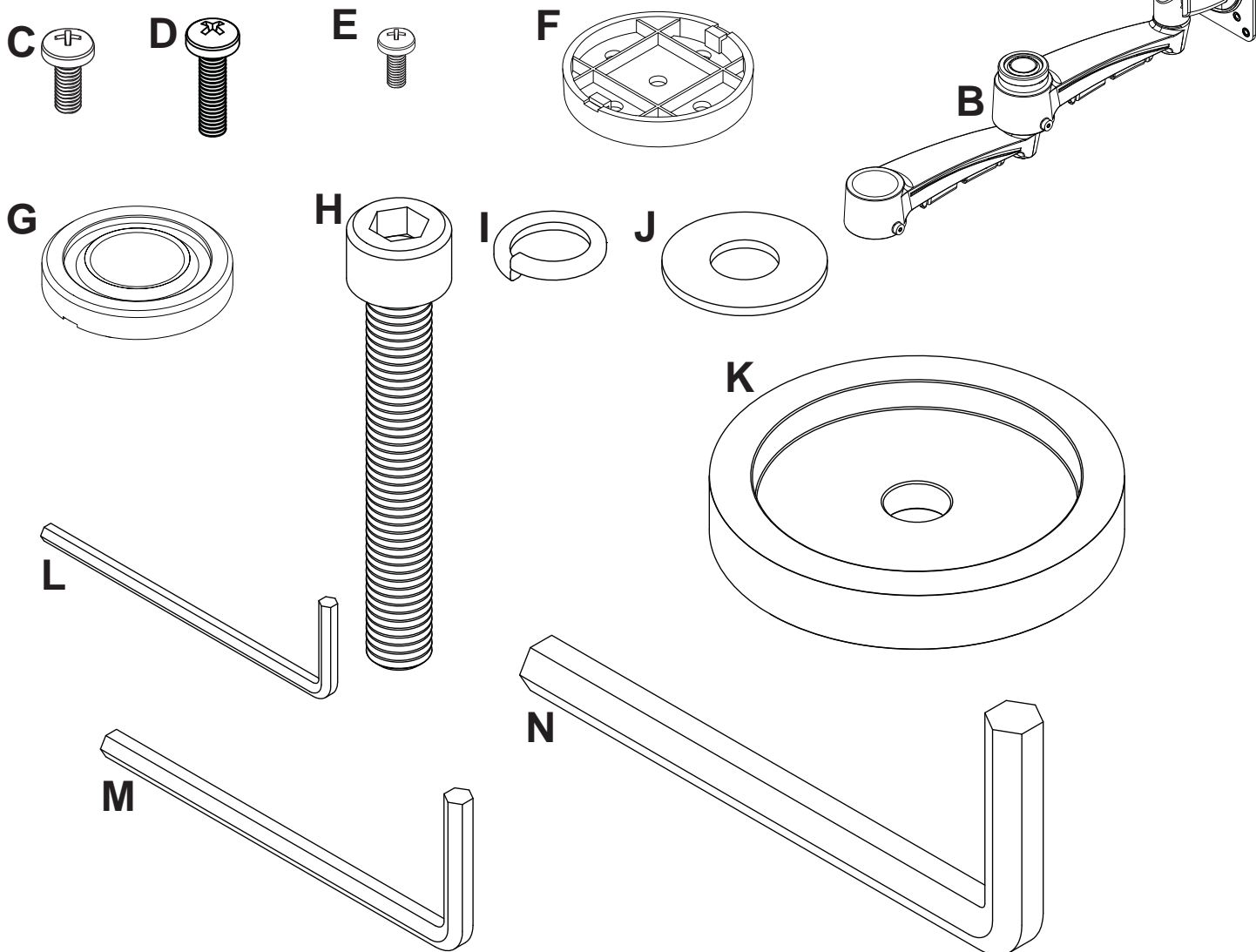

## Clamp Installation Method

- 1 Pipe assembly (A) can be mounted to mounting surface with a maximum thickness of 1-7/8" (48 mm) . Insert the clamp onto mounting surface as shown in figure 1.1. Turn handle to tighten pipe assembly (A) to mounting surface until firmly attached as shown in figure 1.2.

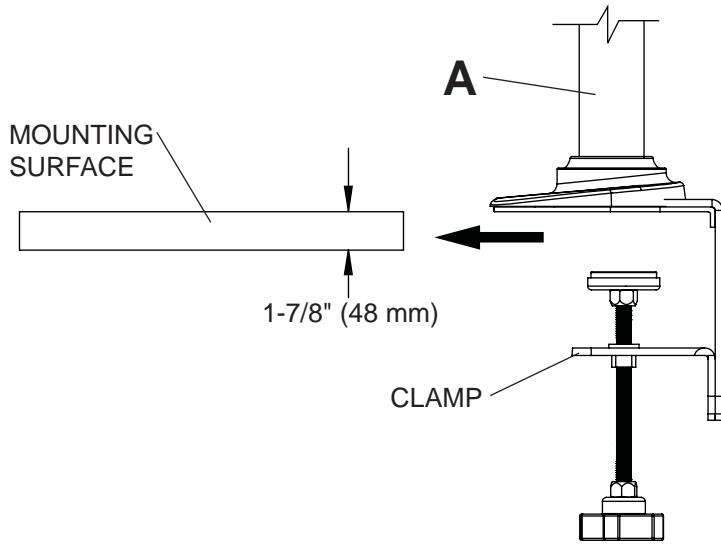

fig. 1.1

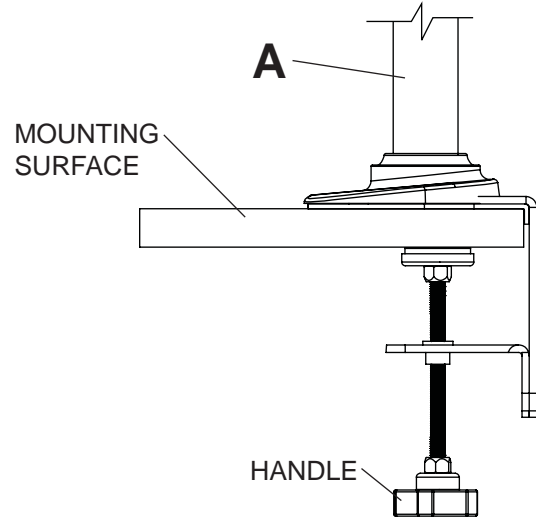
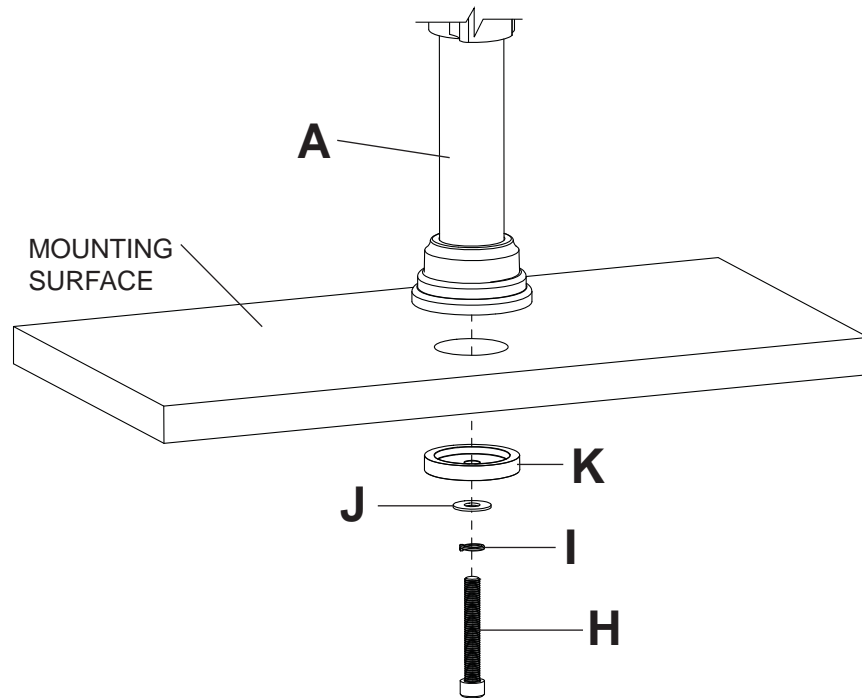

fig. 1.2

## Hole Installation Method

- 2 Drill a .5" (13 mm) hole into mounting surface. Place pipe assembly (A) onto mounting surface and secure using one bolt (H), one spring washer (I), one flat washer (J), and one bottom washer (K) as shown. Tighten bolt (H) using the 8 mm wrench (N).

**NOTE:** Be sure bolt (H) and washers are assembled in correct order as shown below.



## Arm Assembly

- 3 Place arm assembly (B) onto pipe assembly (A). Align pipe bushing with the set screw on arm assembly (B), as shown in detail 1, and position onto bushing.

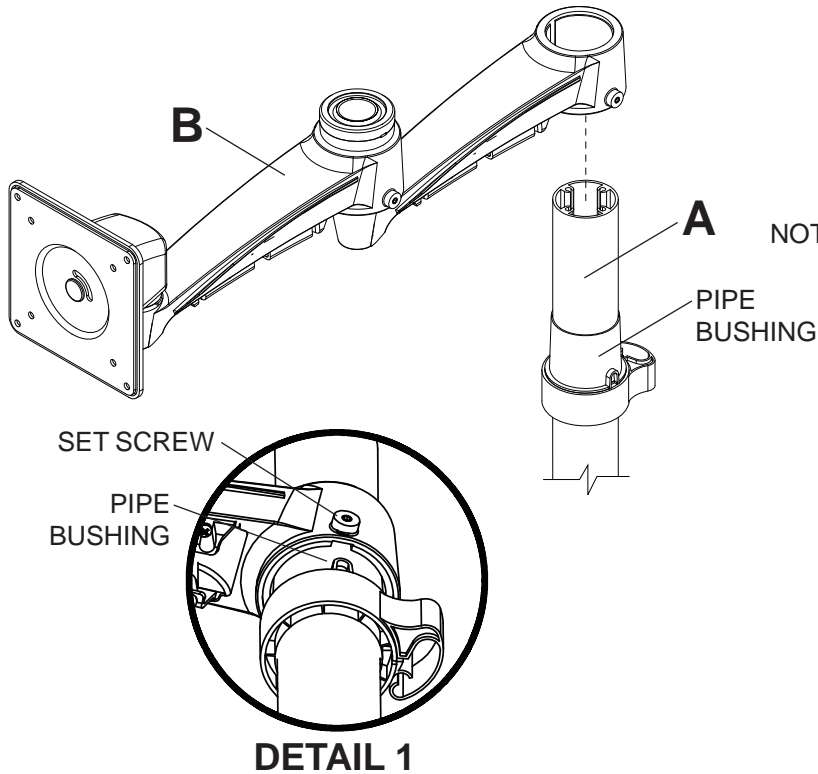

- 4 Attach lower pipe cap (F) to top of pipe assembly (A) using two M4 X 8 mm screws (E). Align the notches in both caps and snap the upper pipe cap (G) onto the lower pipe cap (F) as shown below.

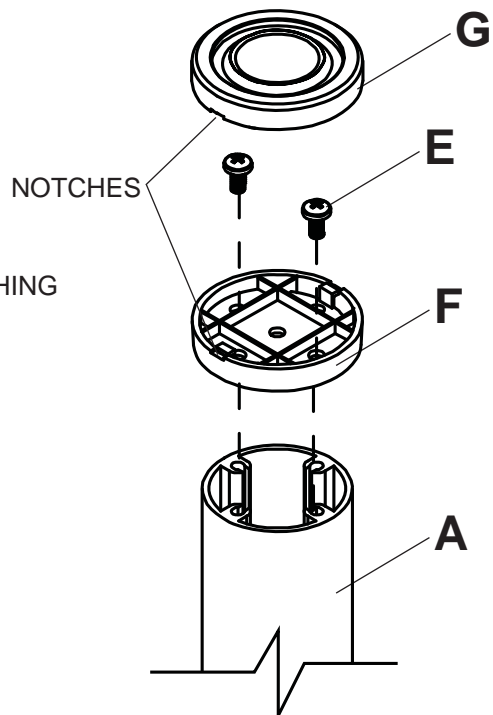

## Arm Height Adjustment

- 5 Adjust the arm assembly (B) to desired height and tighten the set screw using the 2.5 mm allen wrench (L).

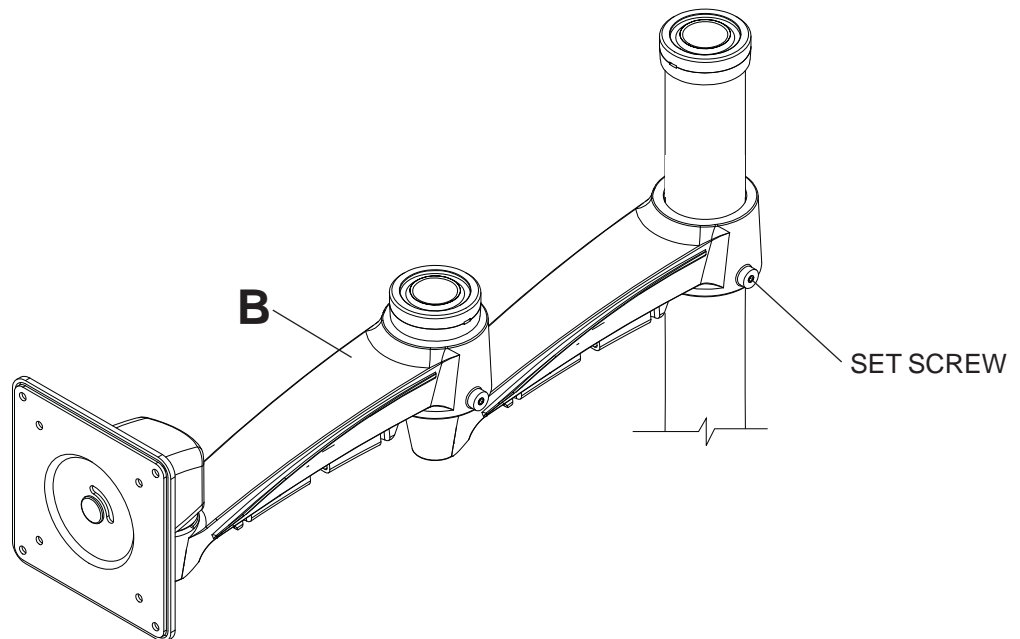

## Installation to Screen

- 6 Attach front of arm assembly (**B**) to back of screen using four screws (**C or D**) using VESA® 75 or VESA® 100 mounting pattern as shown. Re-adjust screen height as necessary.

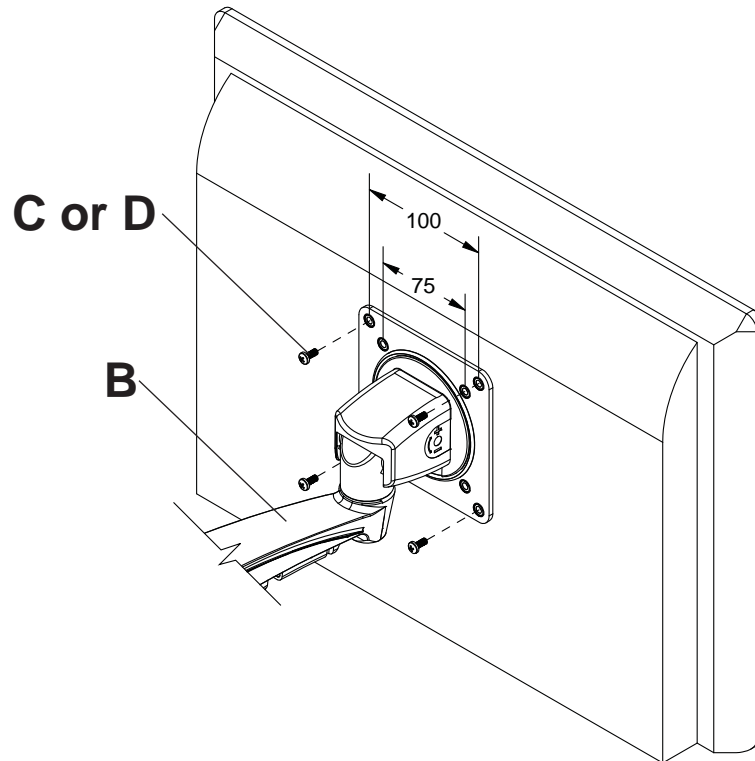

## Control Bolt Tension Adjustment

- 7 **NOTE:** This product is factory set for a 19" (483 mm) screen. When changing the size of the screen, adjust the control bolt using the 4 mm allen wrench (**M**).

Adjust control bolt at top of arm assembly (**B**) as shown using the 4 mm allen wrench (**M**). Turn control bolt clockwise (+) to adjust for weight greater than 8.8 lbs (4 kg). Turn control bolt counter-clockwise (-) to adjust for weight less than 8.8 lbs (4 kg).

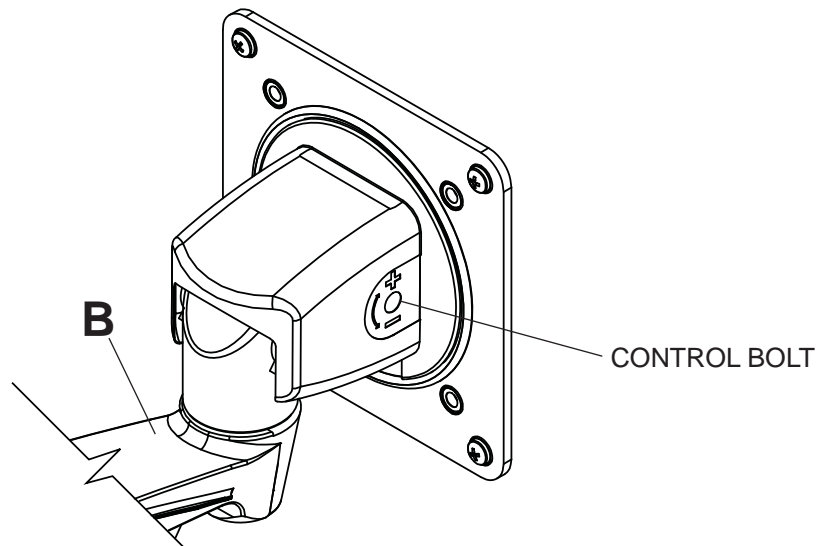

# Cable Management

8

Position cables into cable management channel and cable management clip as shown.

