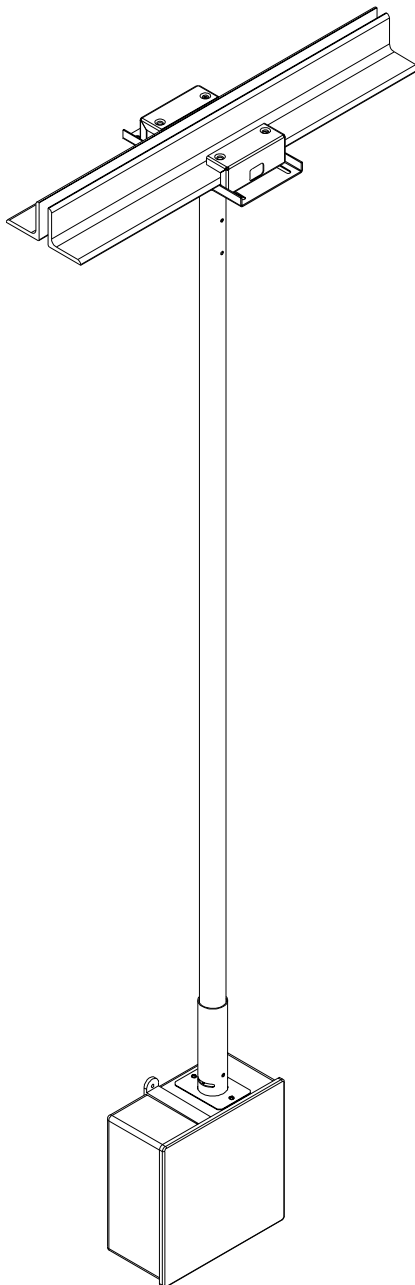


## Installation and Assembly

---

Model: MIS368



Max Load Capacity: 25 lb (11.3 kg)

**Note:** Read entire instruction sheet before you start installation and assembly.

## **WARNING**

- Do not begin to install your Peerless product until you have read and understood the instructions and warnings contained in this Installation Sheet. If you have any questions regarding any of the instructions or warnings, please call Peerless customer care at 1-800-865-2112.
- This product should only be installed by a qualified professional.
- Make sure that the supporting surface will safely support the combined load of the equipment and all attached hardware and components.
- Never exceed the Maximum Load Capacity of 25 lb (11.3 kg).
- Always use an assistant or mechanical lifting equipment to safely lift and position equipment.
- Tighten screws firmly, but do not overtighten. Overtightening can damage the items, greatly reducing their holding power.

### **Tools Needed for Assembly**

- drill
- 13/64" bit for wood or metal
- 2 1/2" hole saw for wood or metal
- tape measure

### **Table of Contents**

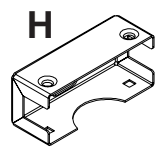
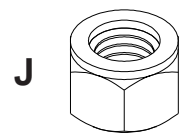
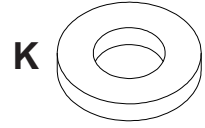
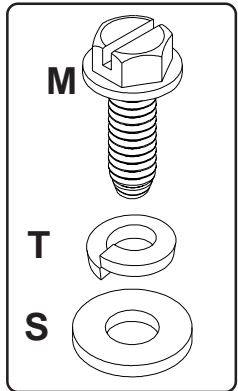
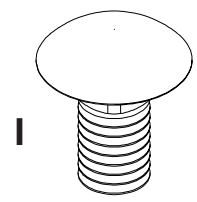
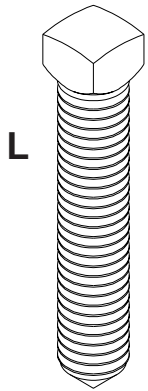
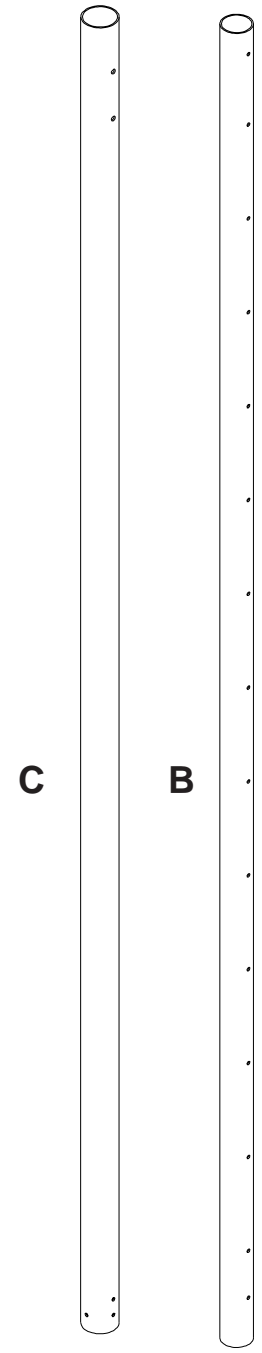
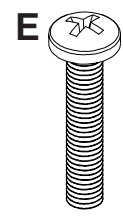
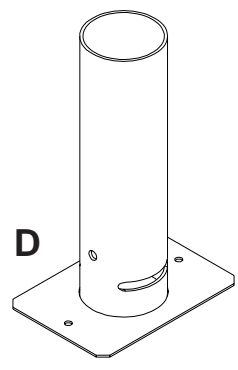
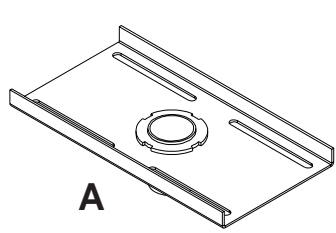
Parts List .....	3
Installation to Ceiling .....	4
Preparing Junction Box .....	6
Installing Junction Box to Adapter Tube .....	7

*For customer service call (800) 865-2112 or (708) 865-8870.*

**Note:** Read instruction sheet before you start installation and assembly.

Before you start check the parts list to insure all of the parts shown are included.

Parts List		MIS368	
Description	Qty.	Part #	
A	1	135-4001	
B	1	135-4006	
C	1	135-4007	
D	1	124-4786	
E	2	520-9514	
H	2	128-4189	
I	4	520-9215	
J	4	530-9310	
K	4	540-9454	
L	4	520-2560	
M	6	520-1321	
S	6	540-9401	
T	6	540-9402	
U	2	530-1020	



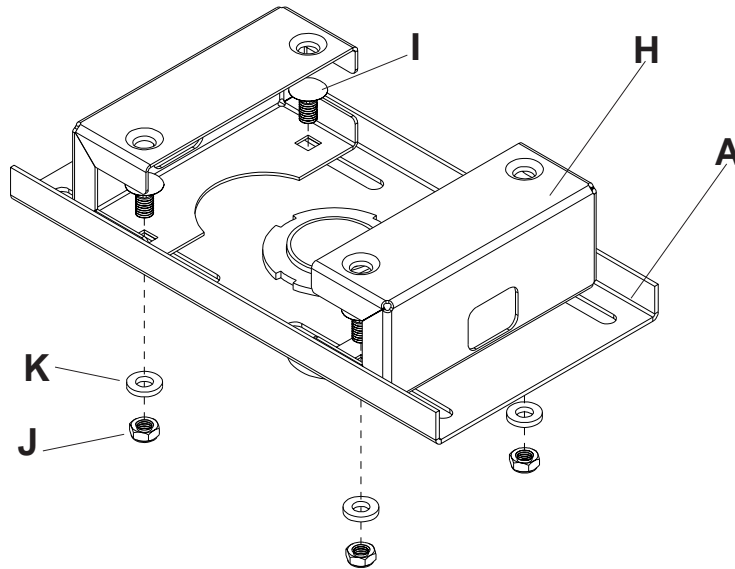
**Note:** Some parts may appear slightly different than illustrated.

## Installation to Ceiling

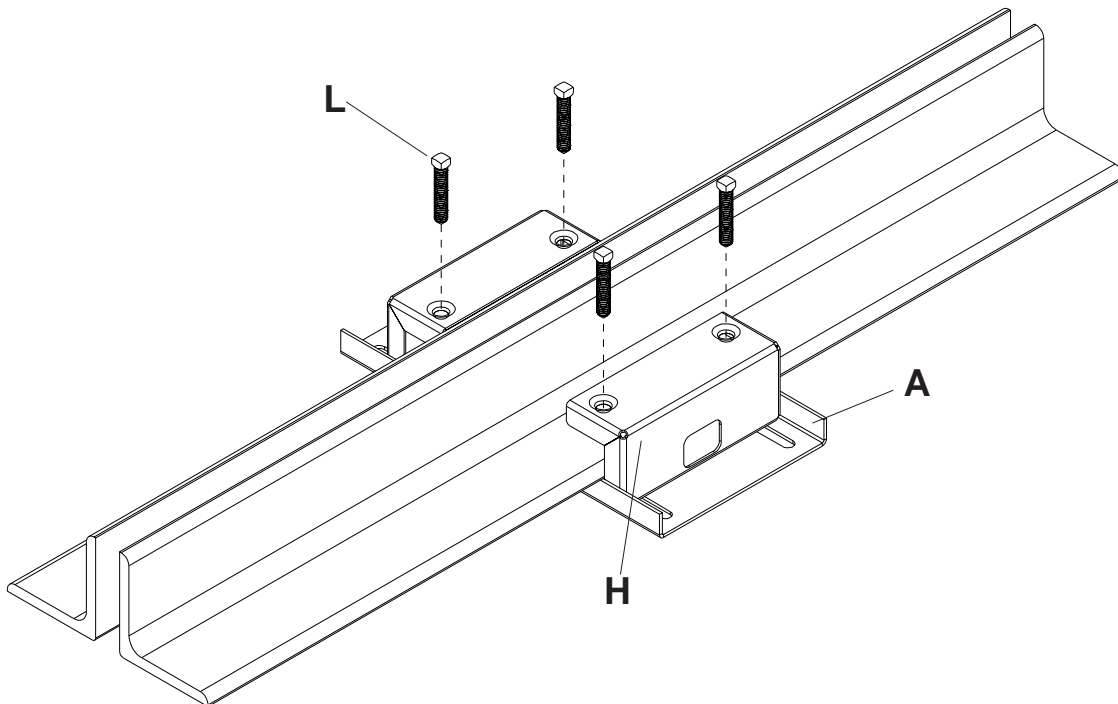
- 1 Attach clamps (H) to tray (A) using four carriage bolts (I), steel flat washers (K), and nylock nuts (J) as shown. Do not fully tighten.

### ⚠ WARNING

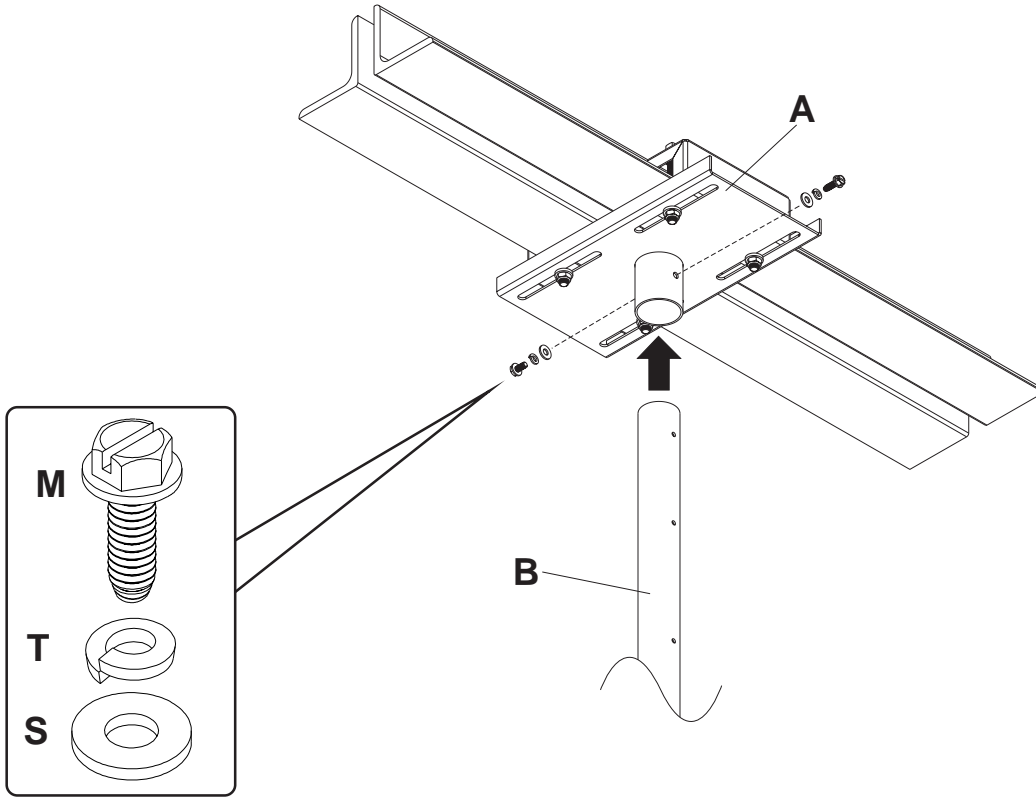
- Make sure that the supporting surface will safely support the combined load of the equipment and all attached hardware and components



- 2 Start four 3/8 x 2" screws (L) into clamps. Adjust clamps (H) securely around I-Beam. Tighten securely. Tighten four 3/8 x 2" screws (L) securely.



- 3** Attach inner tube (B) to tray (A) using two 1/4 x .75" washer head screws (M), two 1/4" flat washers (S), and two 1/4" split washers (T) as shown below. Torque to 50 in. • lb.

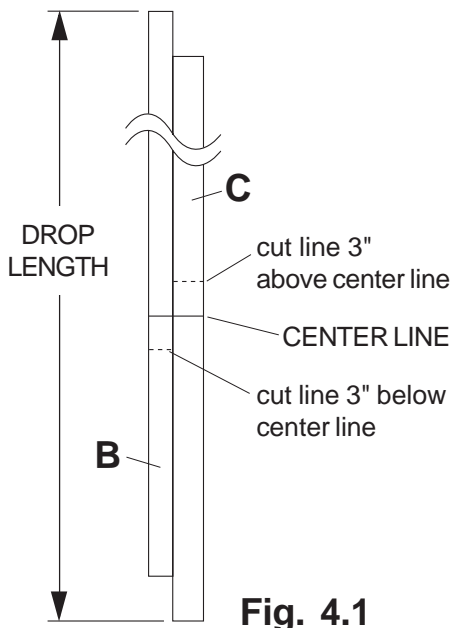


- 4** To reduce the drop length, modify tubes by cutting the lower end of the inner tube (B) and the upper end of the outer tube (C) and then drilling holes in the cut tubes.

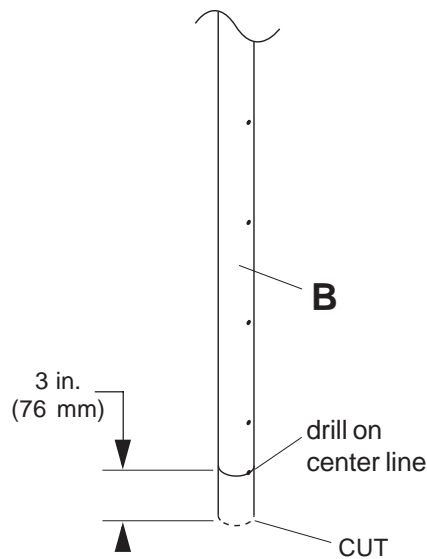
Determine desired drop length distance and place outer tube (C) next to inner tube (B). Mark a line approximately in the center of drop length across both tubes, see figure 4.1.

Cut lower end of inner tube (B) 3" below center line and drill 13/64" hole through both sides on center line, see figure 4.2.

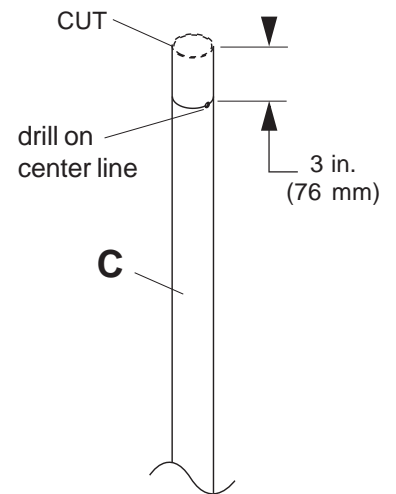
Cut upper end of outer tube (C) 3" above center line and drill 13/64" hole through both sides on center line, see figure 4.3.



**Fig. 4.1**

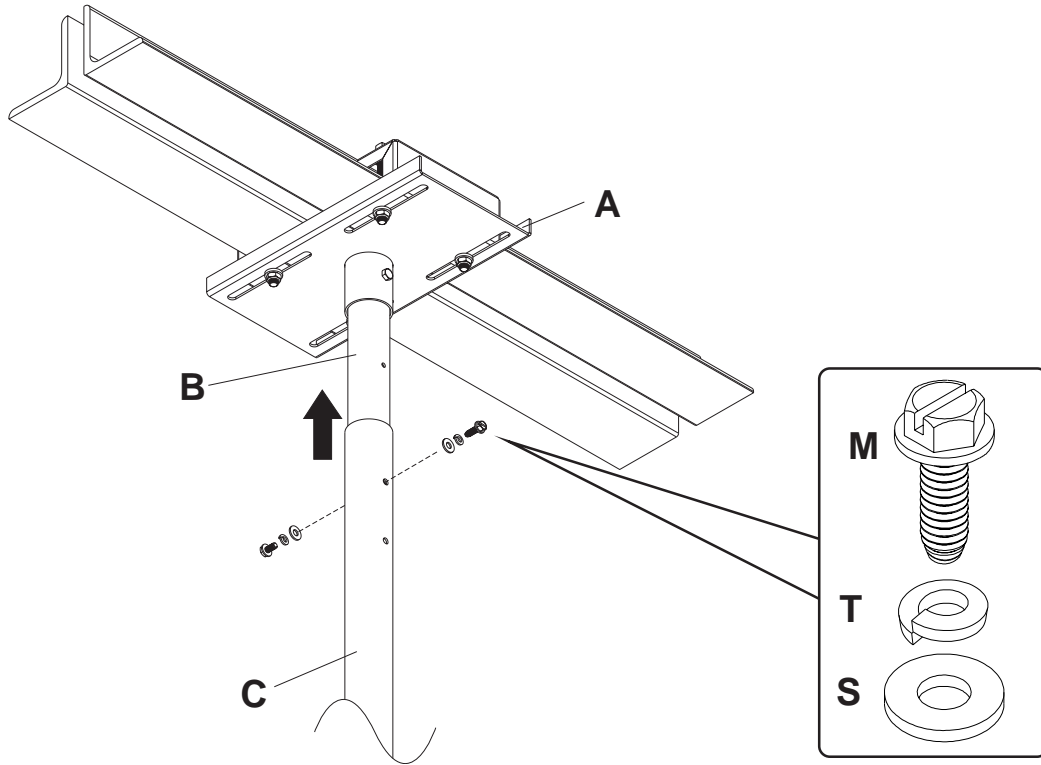


**Fig. 4.2**



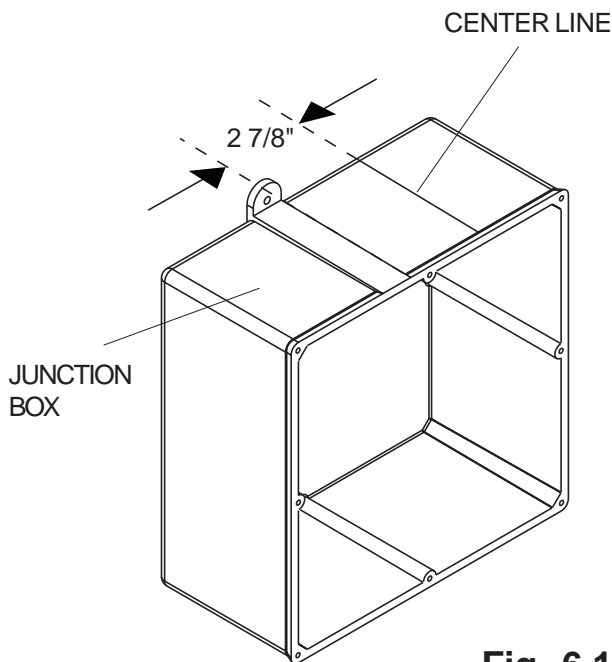
**Fig. 4.3**

- 5** Insert outer tube (C) over inner tube (B). Align holes to achieve the desired drop length of the tubes. Secure outer tube with two 1/4 x .75" washer head screws (M), two 1/4" flat washers (S), and two 1/4" split washers (T). Torque to 50 in. • lb.

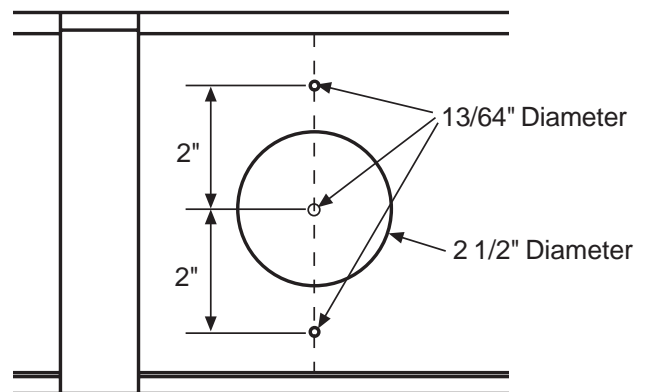


## Preparing Junction box

- 6** Draw a line on top of the junction box 2 7/8" from the edge of the flange as shown in figure 6.1. Mark a point in the center of the line and two points 2" above and below center point as shown in figure 6.2. Drill 13/64" holes on all three points. Using a 2 1/2" hole saw, drill a hole using the center hole as a guide.



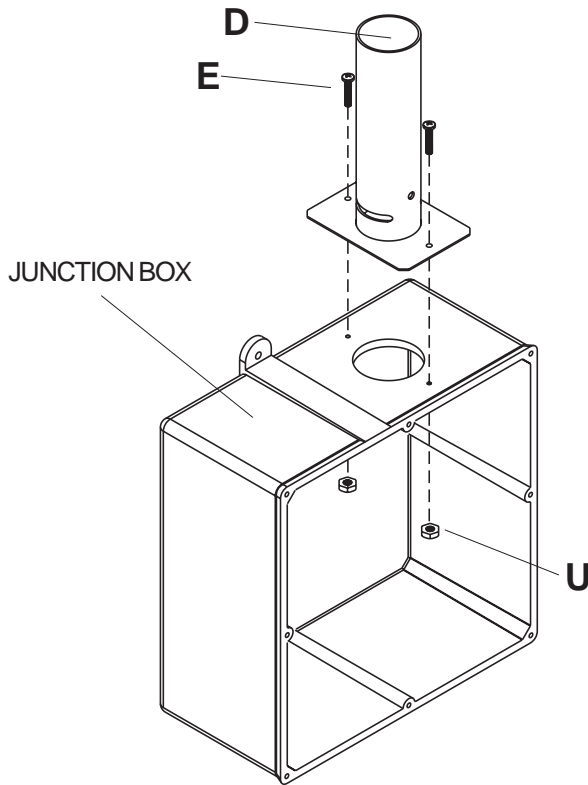
**Fig. 6.1**



**Fig. 6.2**

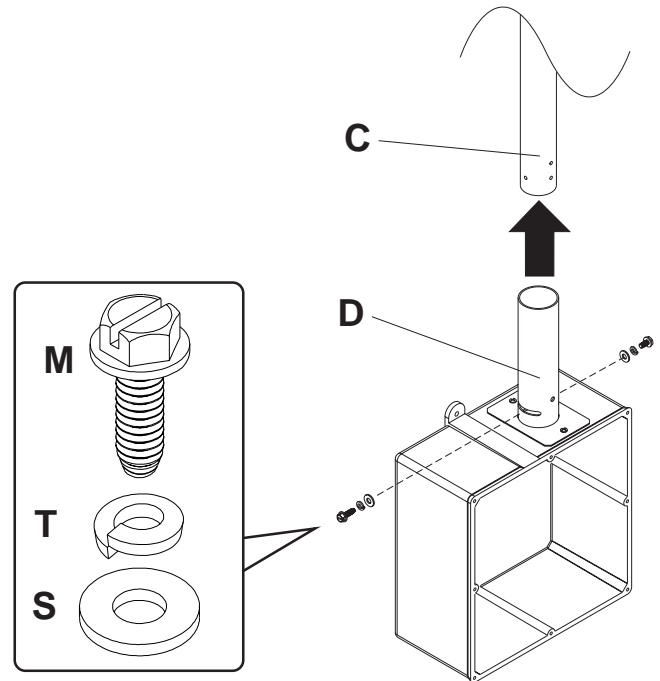
## Installing junction box to adapter tube

- 7** Attach junction box to adapter tube (D) using two 10-32 x 1" philips pan screws (E) and #10-32 serrated flanged lock nut (U).



## Attaching adapter tube to outer tube

- 8** Insert adapter tube (D) over outer tube (C). Align holes to achieve the desired drop length of the tubes and swivel junction to desired position. Secure adapter tube (D) to outer tube (C) with two 1/4 x .75" washer head screws (M), two 1/4" flat washers (S), and two 1/4" split washers (T). Torque to 50 in. • lb.



- 9** Route wiring or cables up through tubing and attach junction box cover.

